



Class I Posi-lock Coupler Installation Instructions

**FOR USE ON TRAILERS WITH 2", 2-1/2", 3" TONGUES
1 7/8" BALL-MAX. GVWR 2,000 LBS.
MAX TONGUE WT. 200 LBS.**

⚠ IMPORTANT – READ INSTRUCTIONS CAREFULLY BEFORE INSTALLATION OR OPERATION. FAILURE TO FOLLOW THESE WARNINGS AND INSTALLATION INSTRUCTIONS WILL RESULT IN SEPARATION OF TOW VEHICLE AND TRAILER, WHICH CAN RESULT IN DEATH, PERSONAL INJURY AND PROPERTY DAMAGE.

Parts List			
ITEM	QTY	PART NUMBER	DESCRIPTION
1	1	Coupler Body	Class I Coupler Body
2	1	0354-11	CPLR-Handle ASM-CL I or II
3	1	0952-09	1/2-20 Nylok thin nut - zinc
4	1	0940-09	Coil Spring
5	1	0975-03	Underjaw Class I - Zinc
6	1	0941-09	Tension Spring

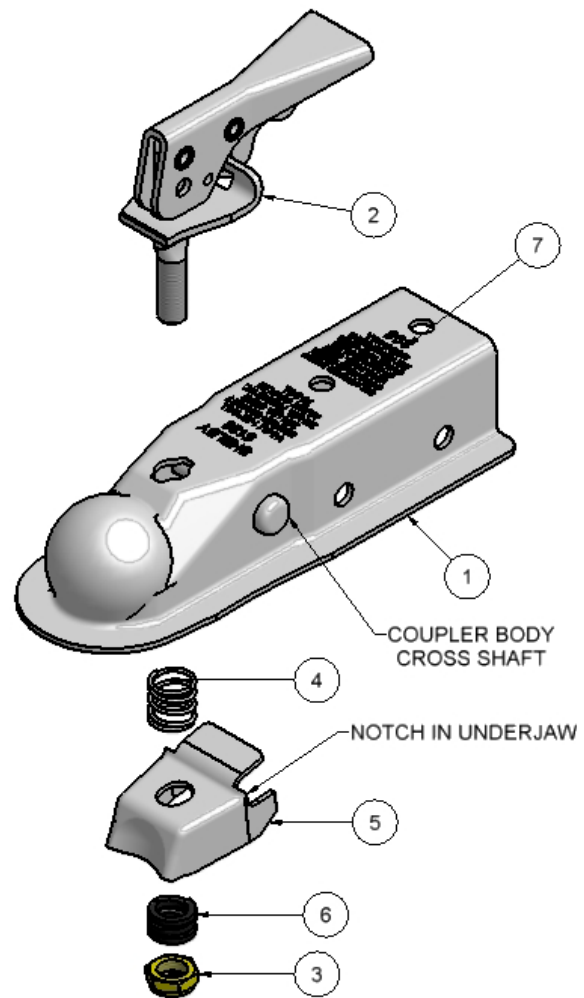
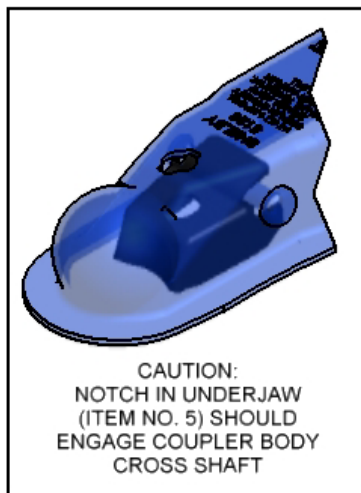

NOTE: Communications regarding this product should refer to part number on this sheet and date code stamped on carton.

1. MOUNT COUPLER SECURELY TO TRAILER TONGUE BY BOLTING OR WELDING. NOTE: TOP HOLES IN COUPLER DO NOT PROVIDE A SAFE OR SECURE ATTACHMENT. USE SIDE HOLES WHEN BOLTING COUPLER TO TRAILER TONGUE.
2. USE ONLY THE CORRECT SIZE BALL AS INDICATED BY THE STAMP ON COUPLER. DO NOT EXCEED WEIGHT CAPACITY OF BALL OR LOAD LIMITATIONS STAMPED ON COUPLER.
3. ADJUST COUPLER LOCKING PRESSURE ON BALL BEFORE USE. PLACE HANDLE IN LOCKED POSITION WITH BALL IN COUPLER. TIGHTEN LOCKNUT AGAINST TENSION SPRING SO THAT COUPLER IS NOT LOOSE ON BALL. CORRECT ADJUSTMENT WILL ALLOW HANDLE TO BE RELEASED WITH MODERATE PRESSURE APPLIED TO RELEASE LATCH.
4. AFTER TOWING 50 MILES, CHECK COUPLER FOR TIGHTNESS ON BALL. ALWAYS CHECK TIGHTNESS BEFORE TOWING. BE SURE LATCH HANDLE IS IN LOCKED POSITION.
5. ALWAYS USE APPROVED SAFETY CHAINS AND HAVE THEM ATTACHED SECURELY
6. THE COUPLER IS SUSEPTABLE TO PHYSICAL DAMAGE WHEN TRAILER IS UNHOOKED. PROP TRAILER TONGUE UP BETWEEN USES. CAREFULLY INSPECT COUPLER FOR DAMAGE AND PROPER ADJUSTMENT BEFORE EACH HOOKUP.
7. ⚠️ **CAUTION:** DO NOT MODIFY COUPLER BY DRILLING OR CUTTING.
8. ⚠️ **CAUTION:** ALWAYS NOTE PROPER INSTALLATION OF UNDERJAW, NOTCH IN UNDERJAW SHOULD ENGAGE COUPLER BODY CROSS SHAFT AT ALL TIMES, FAILURE TO DO SO COULD RESULT IN COUPLER FAILURE.

INSTALLATION NOTE: Check attachment points for electrical wires or hoses before drilling holes.

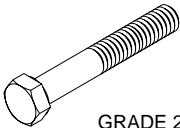
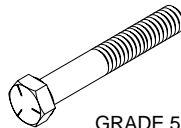
BOLT TORQUE REQUIREMENTS					 GRADE 2	 GRADE 5	METRIC BOLT TORQUE REQUIREMENTS	
Size	Grade	Torque	Grade	Torque			GRADE IDENTIFICATION ON BOLT HEADS	
1/4	2	66 in.lbs.	5	96 in.lbs.	<u>5.8 TO 6.9 GRADE 2</u> <u>8.8 TO 8G GRADE 5</u> TORQUE REQUIREMENTS GRADE 2 8 mm 18 lb. ft. 10 mm 24 lb. ft. GRADE 5 8 mm 32 lb. ft. 10 mm 38 lb. ft.			
5/16	2	11 ft.lbs.	5	21 ft.lbs.				
3/8	2	20 ft.lbs.	5	30 ft.lbs.				
7/16	2	40 ft.lbs.	5	55 ft.lbs.				
1/2	2	65 ft.lbs.	5	75 ft.lbs.				
5/8	2	100 ft.lbs.	5	160 ft.lbs.				
3/4	2	160 ft.lbs.	5	260 ft.lbs.				

For information or assistance regarding this product contact your dealer or write to:
 Customer Service Manager, Shelby Industries, LLC 175 Mc Daniel Rd., Shelbyville, KY 40065 Phone: 502-633-2040

- NOTE: THIS PRODUCT COMPLIES WITH REGULATION V-5 AND CSA STANDARD D-264
- NOTE: SOME STATES REQUIRE CLEAR VIEW OF LICENSE, REMOVE HITCH BALL WHEN NOT IN USE IF IT RESTRICTS VIEW.
- NOTE: THIS PRODUCT COMPLIES WITH SAFETY SPECIFICATIONS AND REQUIREMENTS FOR CONNECTING DEVICES AND TOWING SYSTEMS OF THE STATE OF NEW YORK.